

Parental controls guide

PlayStation VITA (PS VITA) guide

Parental Controls information

Type of guide

Gaming consoles and platforms

Features and Benefits

The PS Vita Parental Controls can make the handheld console safer for your children by restricting games or videos with mature content, disabling the internet browser and blocking adult sites, and restricting how your child can chat on the PlayStation Network.

What specific content can I restrict?



Browser Access



Chatting



Game Ratings



Inappropriate content



Privacy and identity theft



Purchasing

What do I need?

The PlayStation VITA console you wish to apply restrictions to.

PlayStation VITA (PS VITA) guide

- Open the “Parental Controls” application from the home screen. If you are prompted for a 4 digit PIN number the default is “0000”.

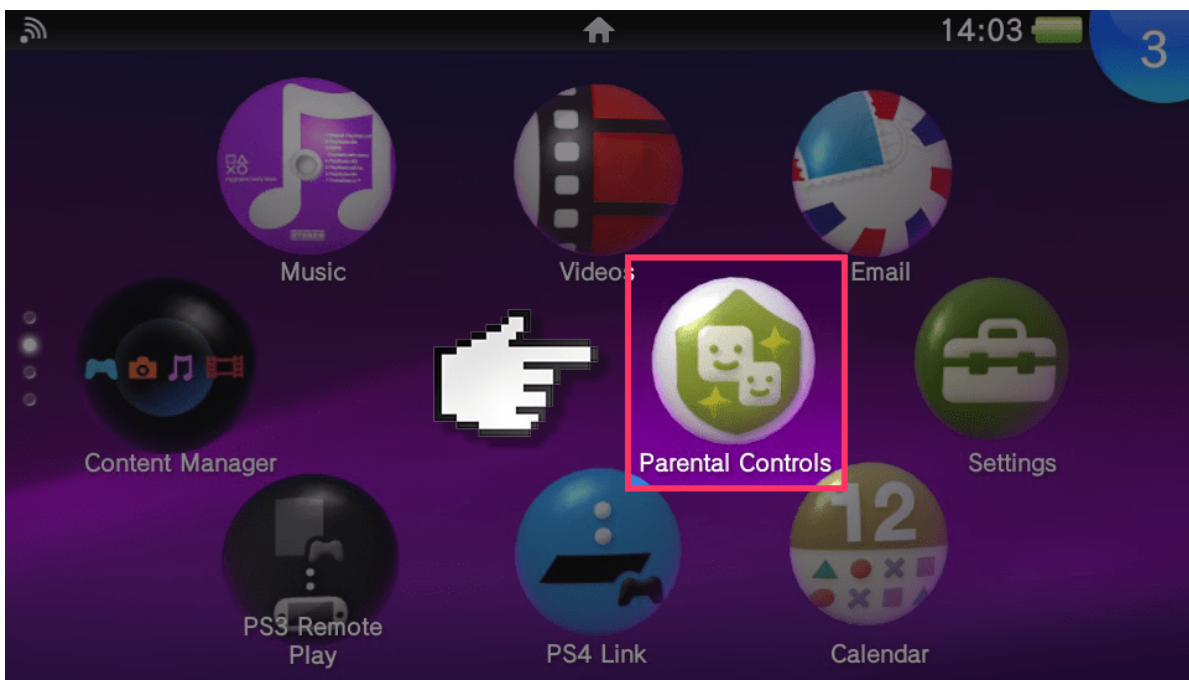

PlayStation VITA (PS VITA) guide



Tap on “Change Passcode”.

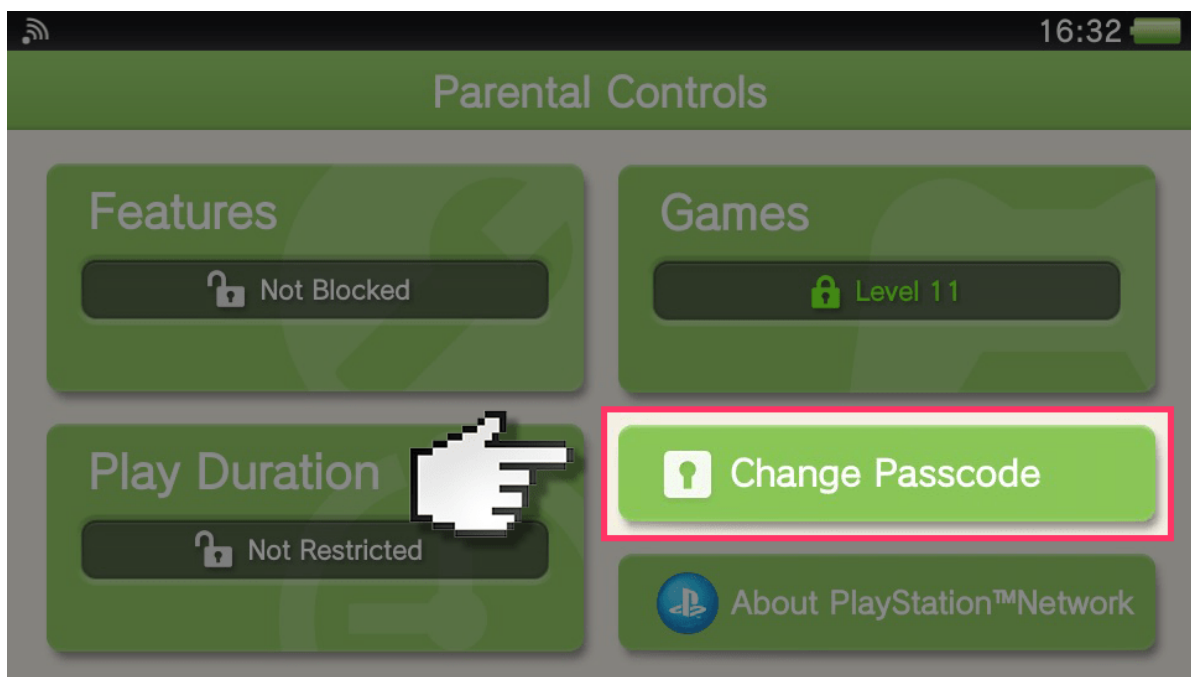

PlayStation VITA (PS VITA) guide

- Set a 4 digit passcode and re-enter to confirm. This passcode will be used to access the Parental Controls in the future and will also be requested when trying to open restricted content.

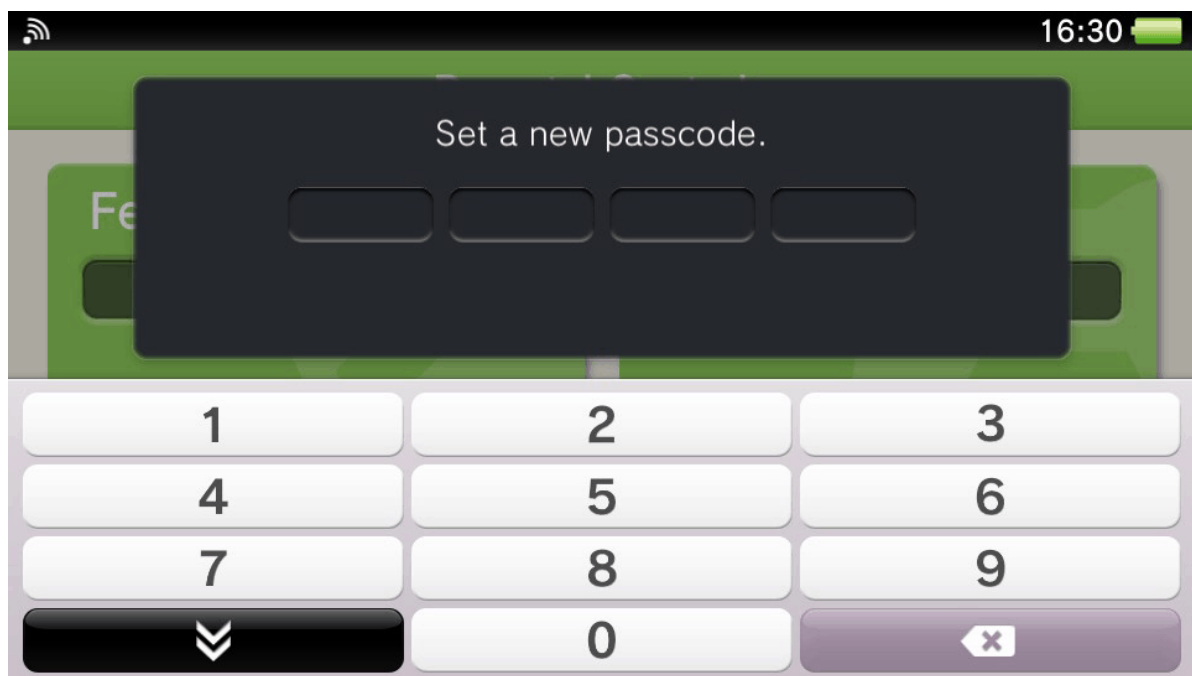

PlayStation VITA (PS VITA) guide



Tap "Features".

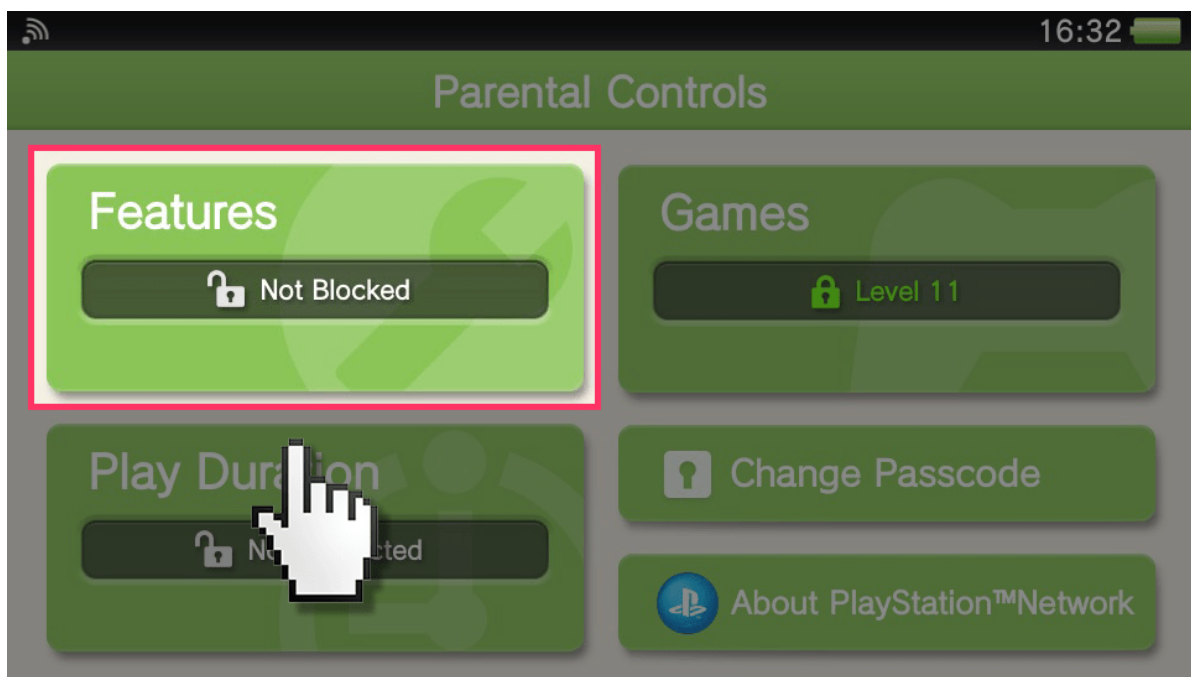

PlayStation VITA (PS VITA) guide



On the “Features” page you can block the use of the Internet Browser, the PlayStation Store, Email use, and Location Data. Tap “OK” to exit.

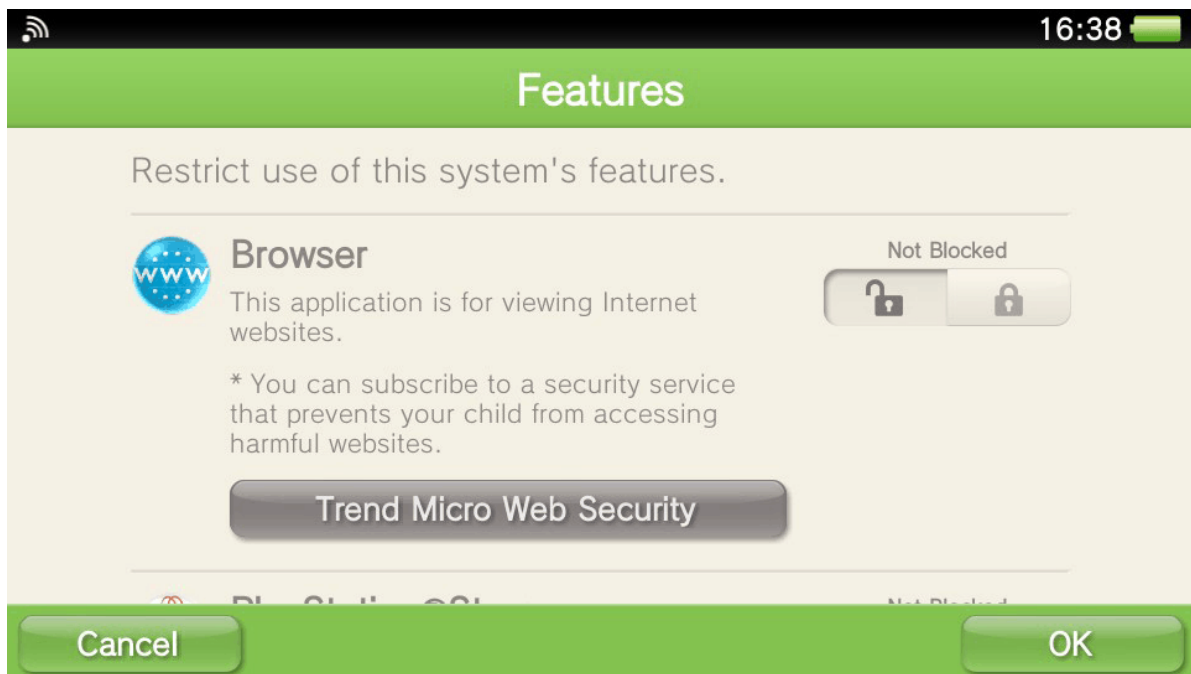

PlayStation VITA (PS VITA) guide



Tap "Games".

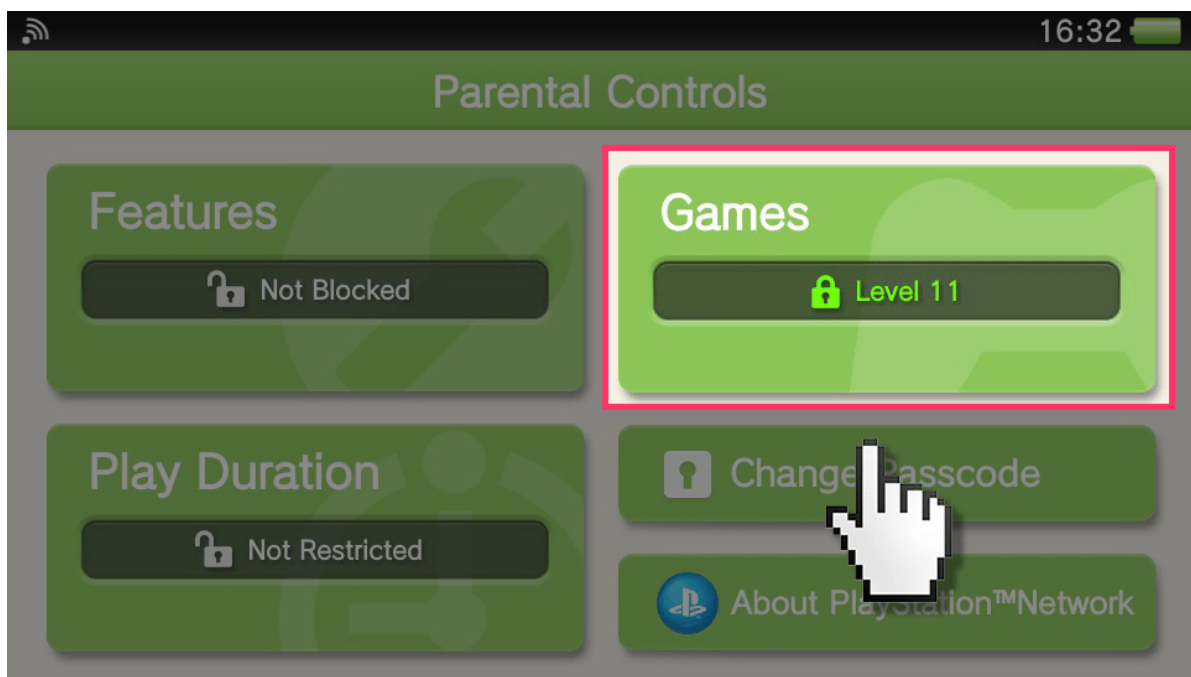

PlayStation VITA (PS VITA) guide

- On the “Games” page you are able to set the maximum PEGI age rating of games that can be run on the system. Tap “OK” to exit.

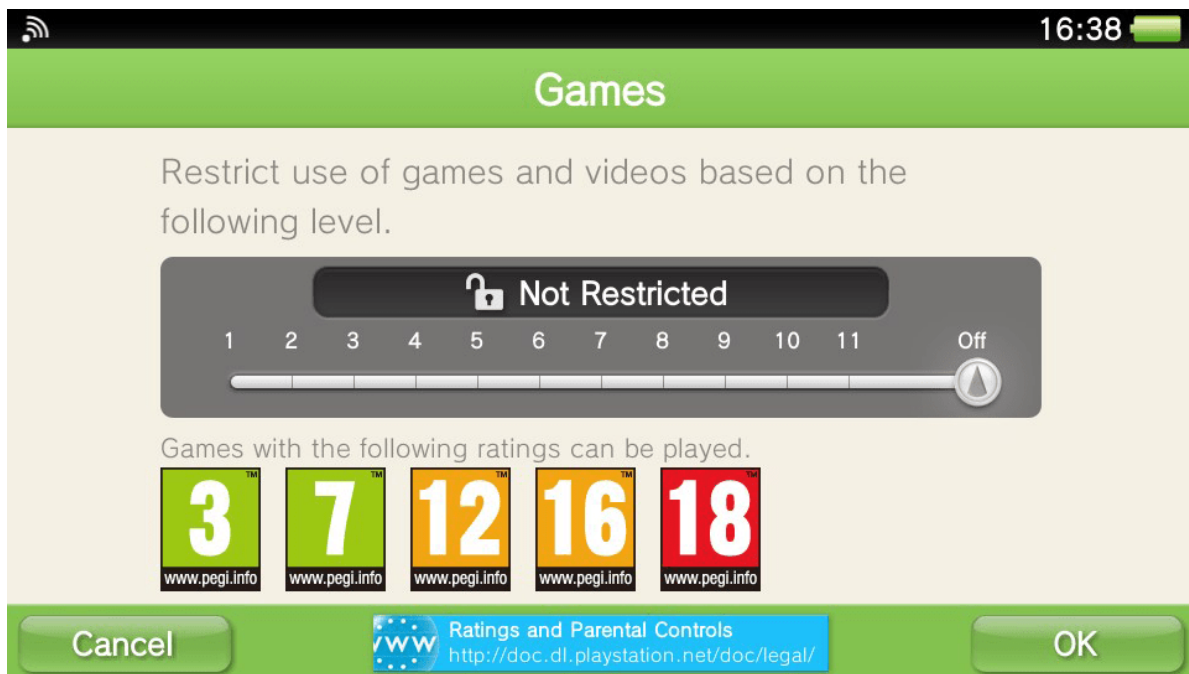

PlayStation VITA (PS VITA) guide



Tap "Play Duration".

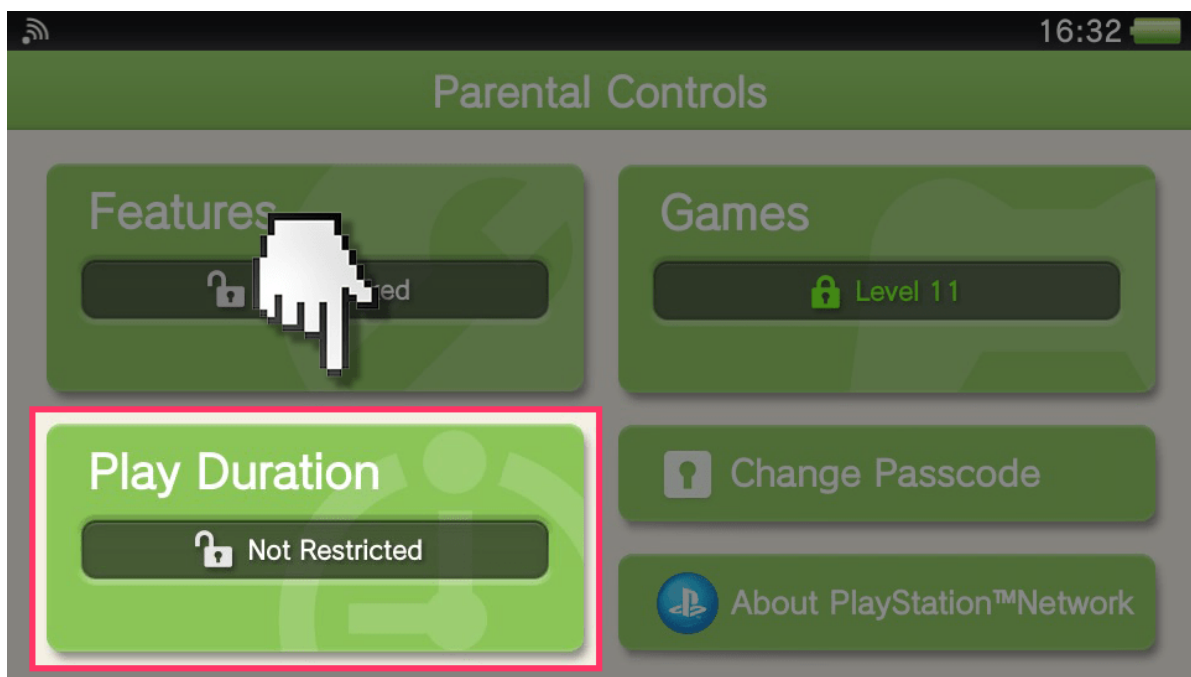

PlayStation VITA (PS VITA) guide



On the “Play Duration” page you can set the time that the system can be used either as a daily maximum or set a maximum for each day of the week. Tap “OK” to exit.

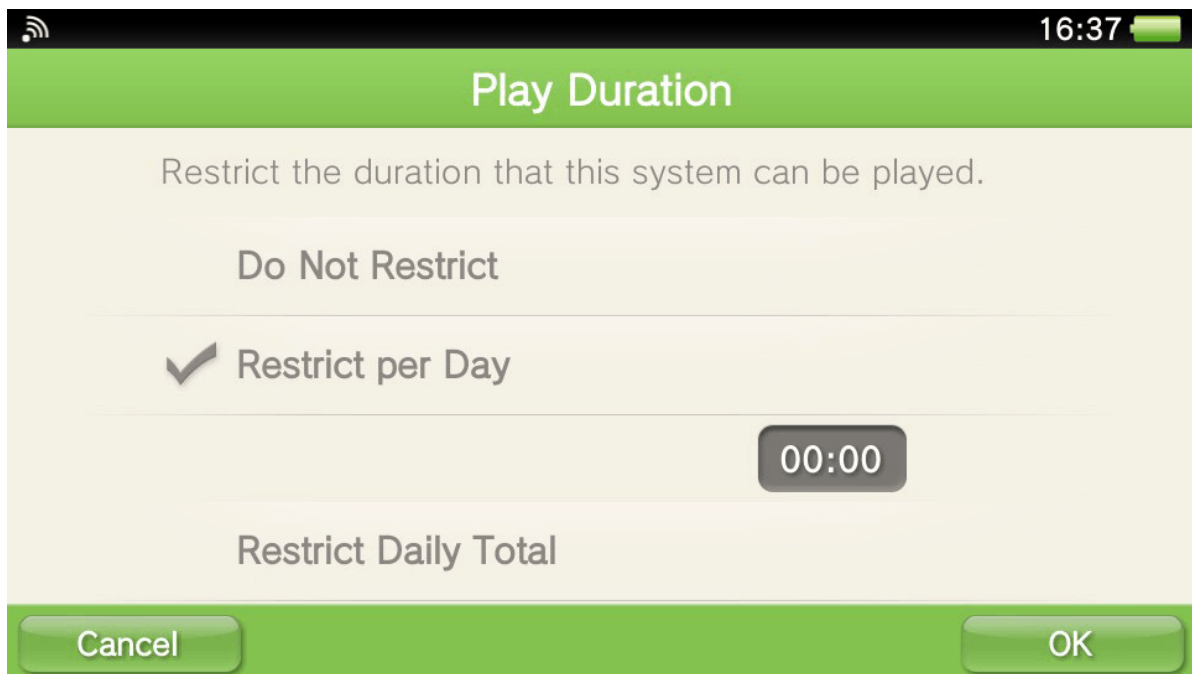

PlayStation VITA (PS VITA) guide



You will also see a link called “About PlayStation Network”. Setting up Parental Controls for the PlayStation Network can be found in a separate guide. Press the blue PlayStation button on the bottom-left front of the console to exit the Parental Controls section.