

Parental controls guide

Google Safe Search guide

Parental Controls information

Type of guide

Entertainment & Search engines

Features and Benefits

SafeSearch can help you block inappropriate or explicit images from your Google Search results. The Safe Search filter isn't 100% accurate, but it helps you avoid most violent and adult content.

What specific content can I restrict?



Innapropriate content

What do I need?

A Google Account (Email address and Password)

Google Safe Search guide



SafeSearch can be easily turned on for a single use, but for it to stay on you will need to lock SafeSearch. While on your browser go to [google.co.uk](https://www.google.co.uk) and click the 'Settings' tab and click on 'Search Settings'.

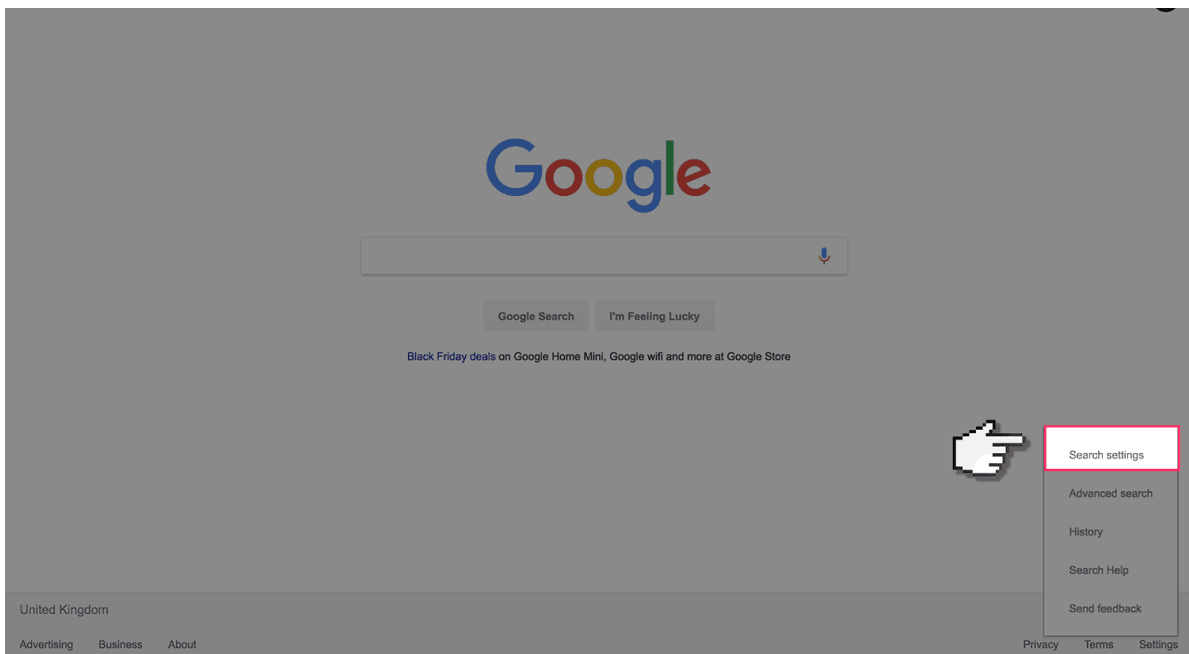

Google Safe Search guide



Find the “SafeSearch Filters” section and check the ‘Filter explicit results’ box, then click on ‘Lock SafeSearch’.

The screenshot shows the Google Search Settings page. The 'SafeSearch Filters' section is highlighted with a red rectangular box. A hand cursor is pointing at the 'Lock SafeSearch' link. The page includes a sidebar with 'Search results', 'Languages', and 'Help'. Below the highlighted section, there are settings for 'Results per page' (a slider from 10 to 100) and 'Private results' (radio buttons for 'Use private results' and 'Do not use private results'). At the bottom, there are 'Spoken answers' settings (radio buttons for 'Speak answers for voice search' and 'Just show text').

Google Safe Search guide



When prompted, sign in to your Google Account. If you haven't got an account click the "Create an Account" button.

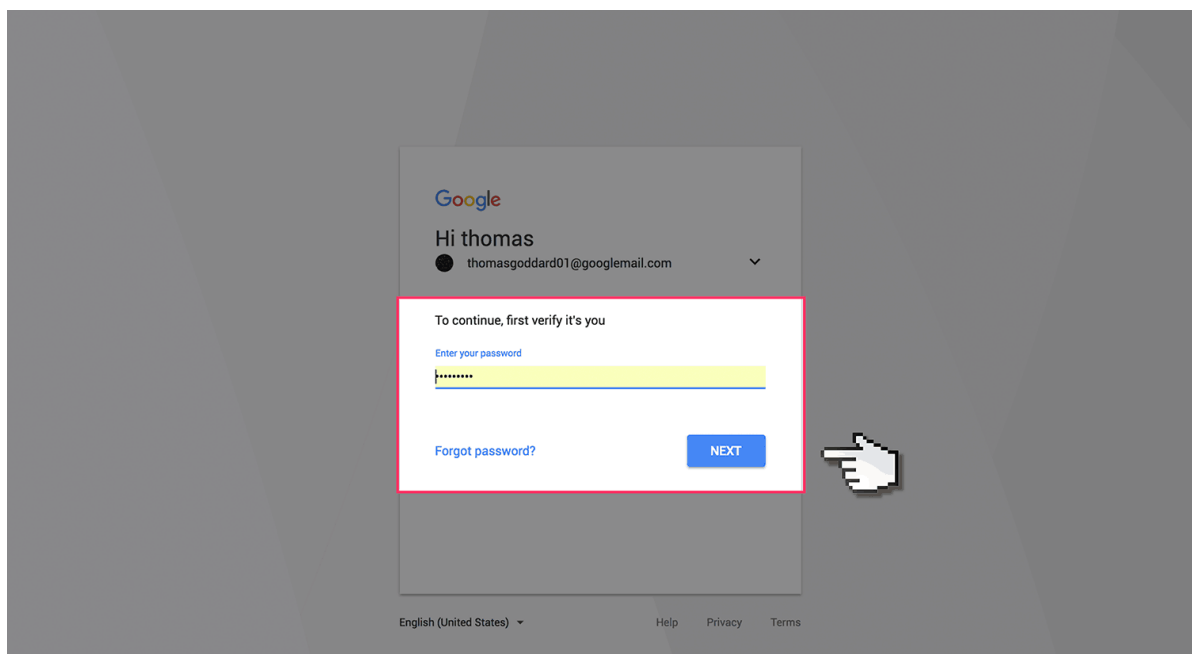

Google Safe Search guide



Finally, to confirm, click the “Lock SafeSearch” button. You will need to do this on each browser that you use or if you have multiple Google Accounts.

