



Nintendo Wii U Safety Controls & settings guide

The WiiU Parental Controls allow you to set restrictions for each family member, giving control over what games can be played or downloaded and how your children can search and interact online.

1

How to set parental controls on Nintendo Wii U

Step 1 – From the Wii U Menu select “**Parental Controls**”.

Then read the following two messages, tapping “Next” or pressing the A button will dismiss them.

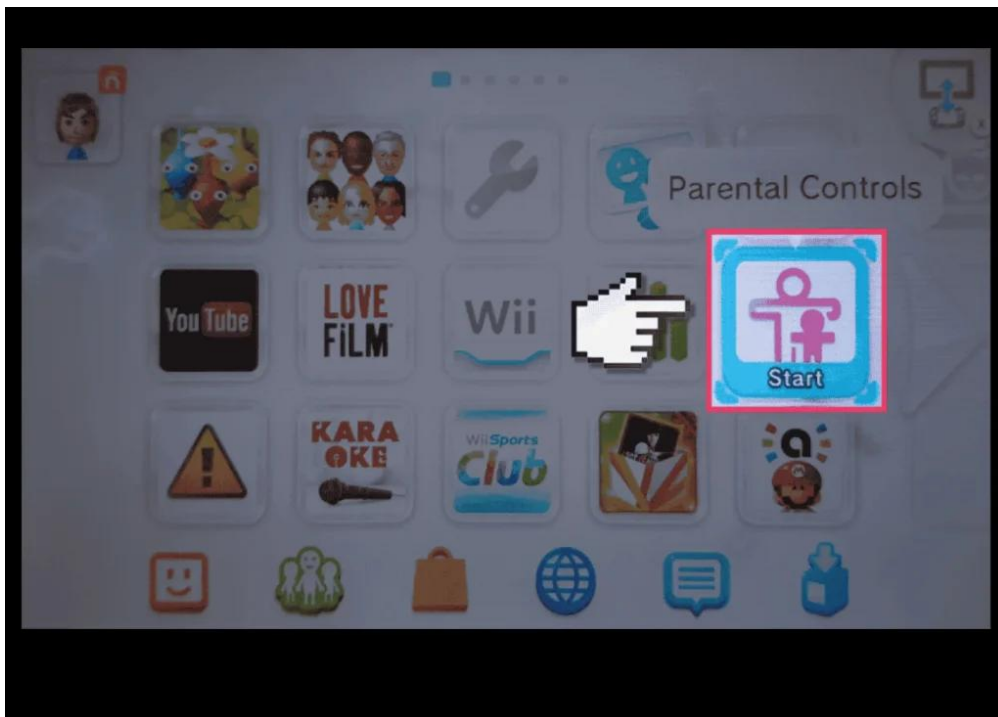

Step 2 – Enter a **4 digit PIN** and then tap “**OK**”.

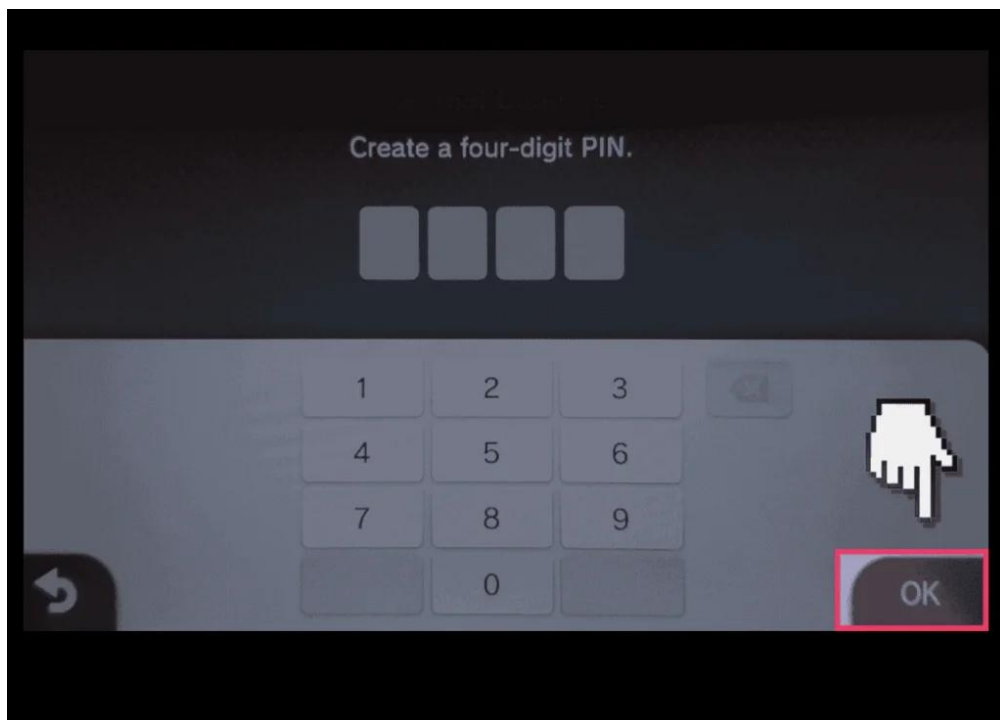

Step 3 – You'll be asked to select a secret question.

This will be used to help you recover your PIN should you forget. Tap **"OK"**.

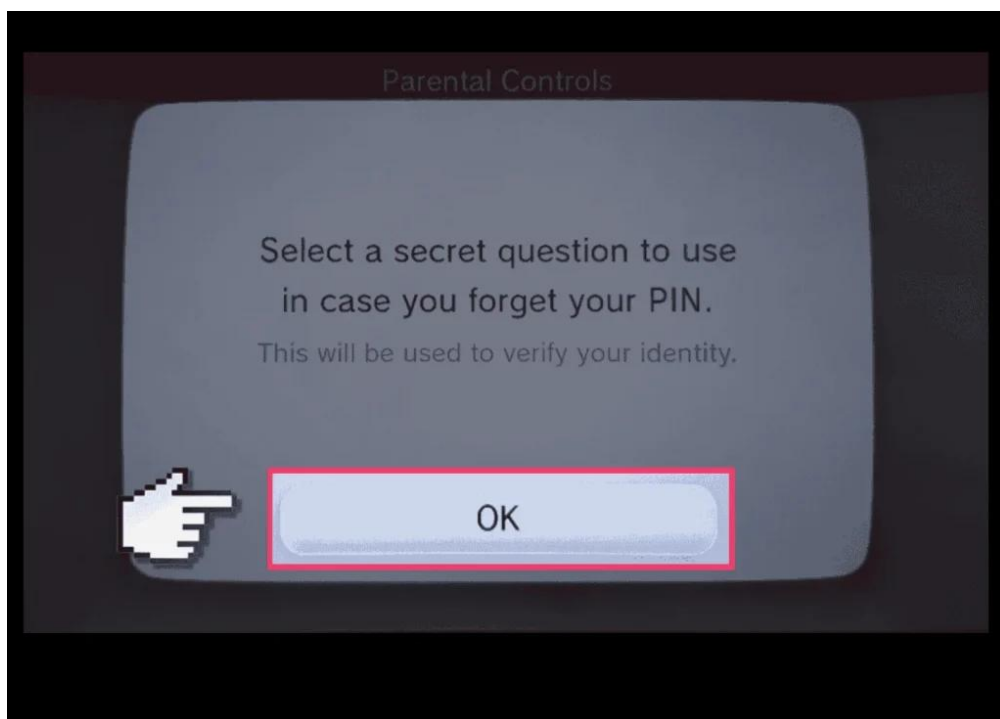

Step 4 – Select a question and then supply an answer and tap **"OK"**.

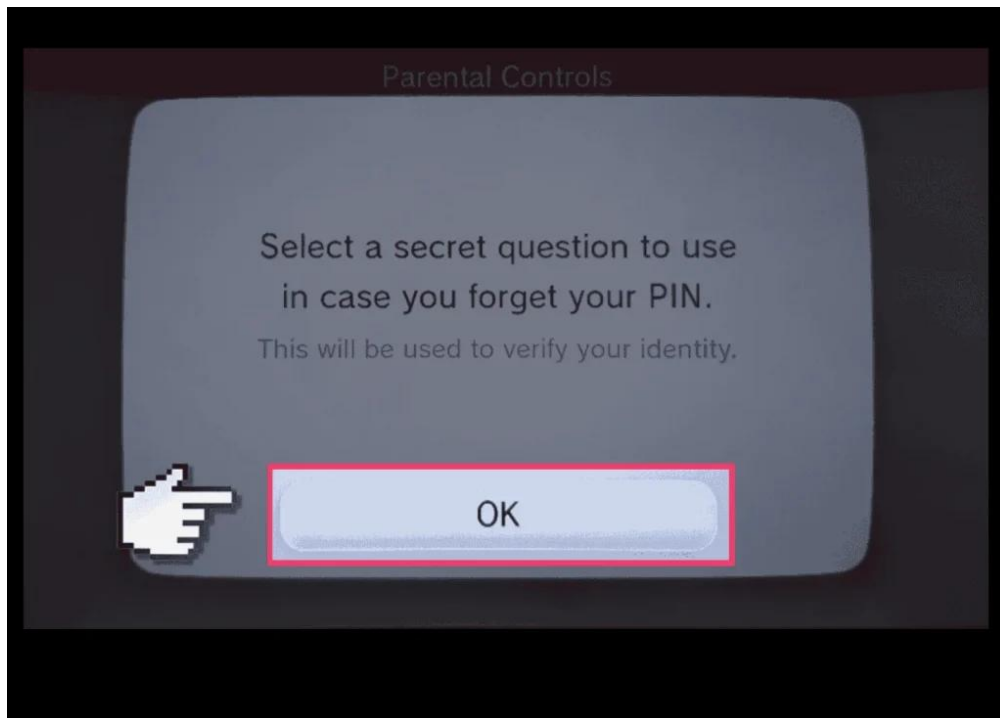

Step 5 – Register your email.

Finally, you will be asked to register an email address. Tap “Next” or press the A button and complete the email registration.

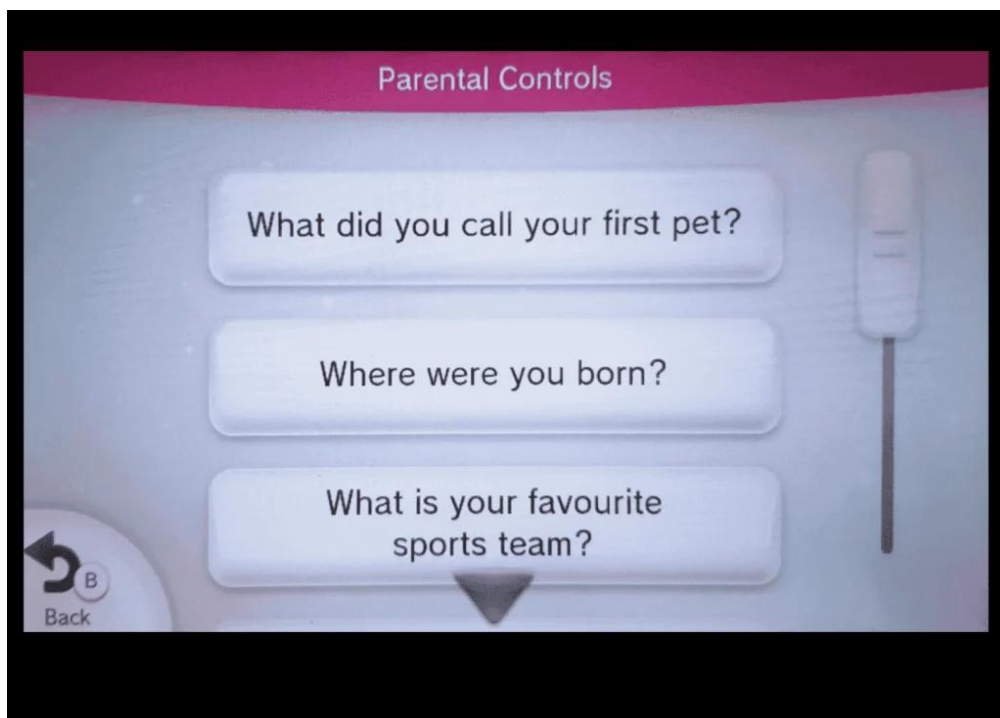

Step 6 - Navigate Parental Controls section.

Use the arrows or left and right on the d-pad to navigate to the user who you want to apply restrictions to.

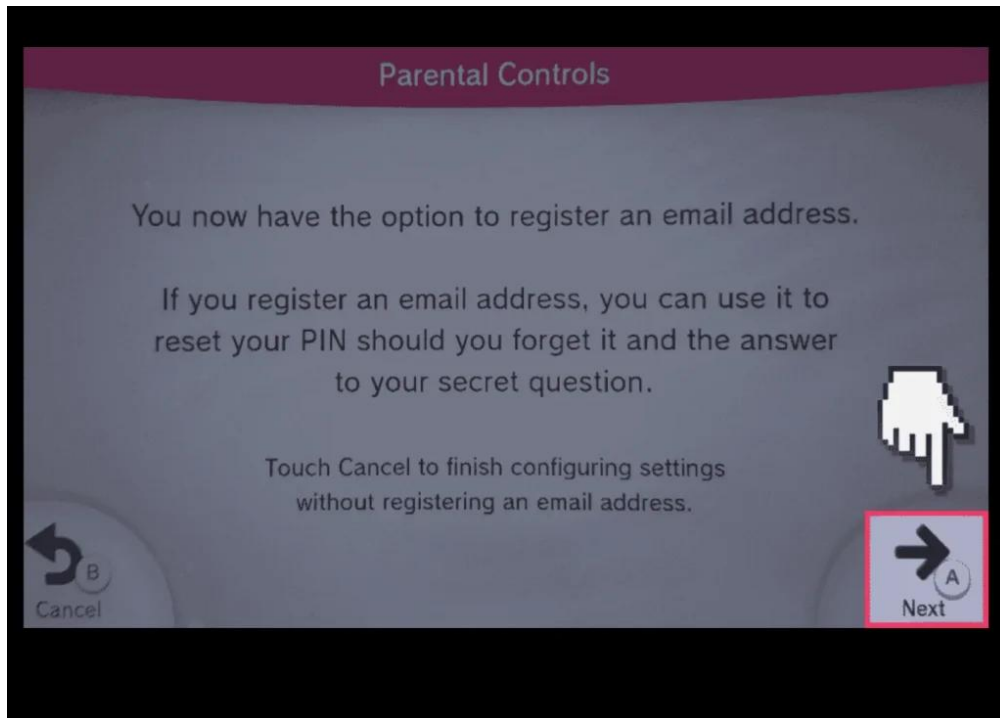

Step 7 - Navigate to settings

With the desired user selected press up/down on the d-pad to navigate to the settings you would like to change and tap the setting or press the A button.

Once you have made the changes you wish to make tap "Back" or press the B button to exit and save your changes.

